

Component Placing, Electrical

Applicable for W380, Z555

Contents

1	Mounting drawing table	2
2	Mounting drawing 1200-7163.2	3
3	Revision history.....	6

1 Mounting drawing table

Board Number	Drawing	Comments
1200-6064 1200-9524	1200-7163.2	

By using the “Search” function and entering the component name you can find the position of the component (Use Adobe Reader 7.0 or a later version). Example: You can see the component name highlighted on the circuit board (use zoom to enlarge).

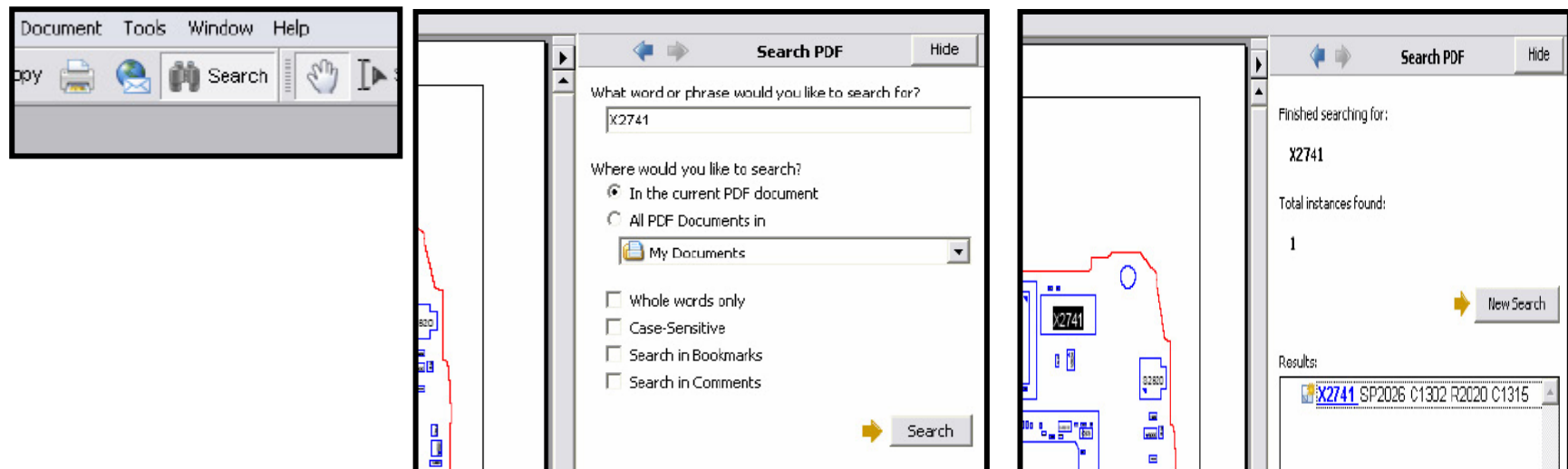

2 Mounting drawing 1200-7163.2

1200-7163.2 Primary Side

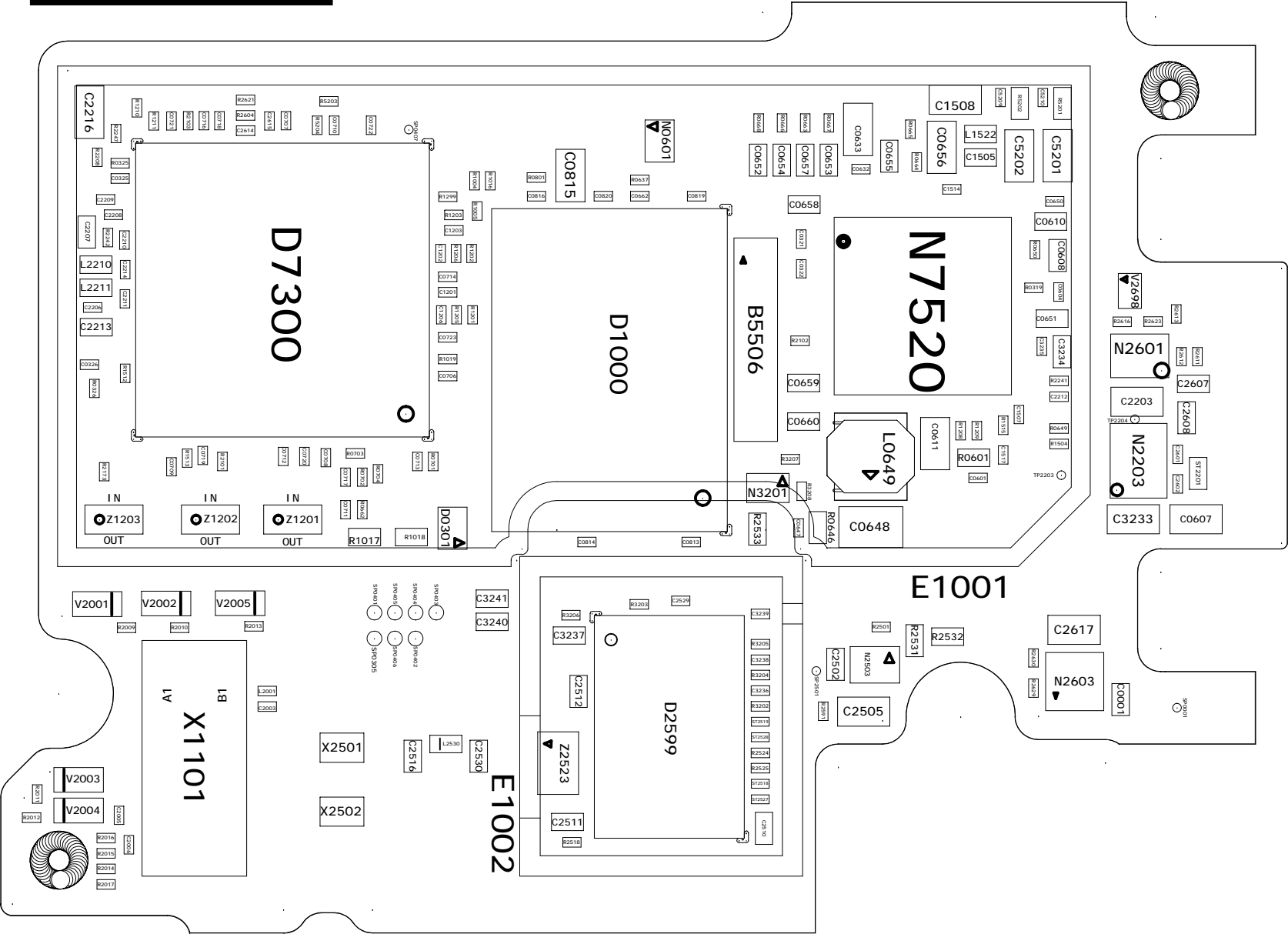

1208-3991.1

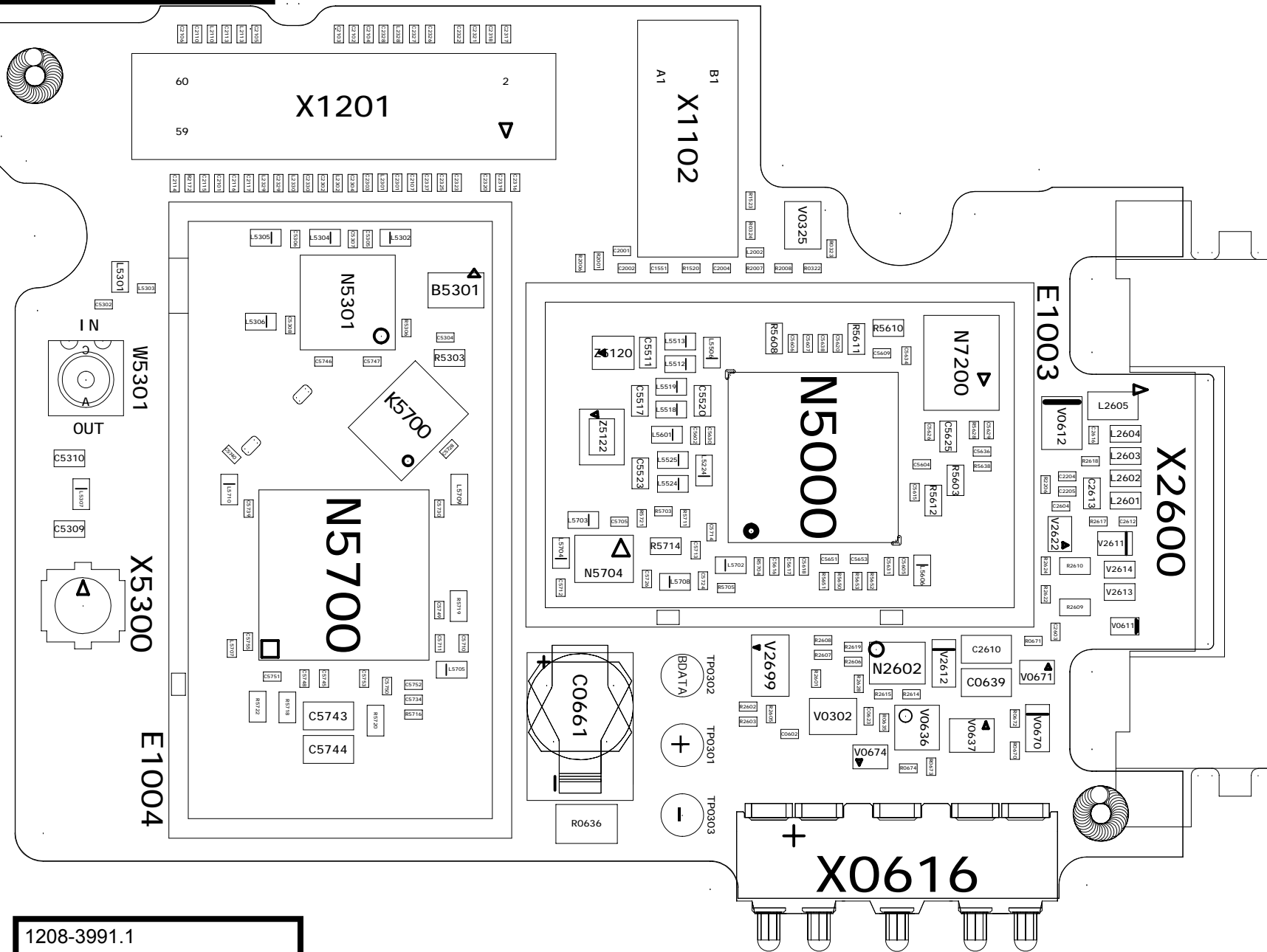

3 Revision history

Rev.	Date	Changes / Comments
1	2008-Feb-29	Initial Release